

Terminal Function of IC's

IC901 (M3819MA146F...for [E] area/M38197MA180F...for [EG] area): SYSTEM CONTROL/FL DRIVE

Pin No.	Terminal Name	I/O	Function
1	KEY-TU	I	Tuner operation switch signal input
2	KEY-CH	I	Input selector operation switch signal input
3	KEY-SE	I	SE-HD51 operation switch signal input
4	KEY-CD	I	SL-HD51 operation switch signal input
5	NC	—	Not used, open
6	DATA 1	O	Serial data output terminal
7	CLK 1	O	Serial clock signal output terminal
8	DATA 2	O	Serial data output terminal
9	CLK 2	O	Serial clock signal output terminal
10, 11	NC	—	Not used, open
12	SEL-TU	O	Tuner select signal output
13	STB	O	Strobe signal output
14	NC	—	Not used, open
15	CE	O	Chip enable output
16	DATA IN	I	Serial data input terminal
17	CEO	O	Serial data output terminal for (EG) area only
18	DATA I/O	I/O	Serial data input/output terminal for (EG) area only
19	CD & DECK & MD CS	I	Serial data input terminal
20	CD & DECK & MD SCLK IN	I	Serial clock signal input terminal
21	CD & DECK & MD SDA OUT	O	Serial data output terminal
22	CD & DECK & MD SDA IN	I	Serial data input terminal
23	MD CS	I	Chip select signal input for MD
24	MD REQ	O	Request signal output for MD
25	DECK REQ	O	Request signal output for RS-HD81
26	CD REQ	O	Request signal output for SL-HD51
27	CHECK	O	Clock checking terminal
28	CR TIMER	I/O	Capacitor and resistor oscillation terminal

Pin No.	Terminal Name	I/O	Function
29	CEI	I	Serial data input terminal for (EG) area only
30	REMOCON	I	Remote control signal input
31	V-JOGB	I	Volume control signal input
32	V-JOGA	I	
33	ACK DK	I	Serial data input for RS-HD81
34	AC IN	I	AC power in detection signal input
35	RESET	I	Reset signal input
36	SD	I	SD control signal input for tuner circuit
37	STEREO	I	STEREO signal input for tuner circuit
38	XIN	I	Connected to the ceramic oscillator
39	XOUT	O	
40	Vss	—	GND terminal
41	MUTE	O	Muting control signal output
42	POWER	O	Power ON/OFF control signal output
43	CSI 2	I	Connect to GND through the resistor
44	CSI 1	I	
45	CSO 3	O	Connect to GND through the diode
46	OSO 2	O	Not used, open
47	CSO 1	O	Connect to GND through the diode
48 ~ 60	G13 ~ G1	O	Grid control signal output
61 ~ 90	P36 ~ P7	O	Segment control signal output
91	VCC	—	Power supply (+5V)
92 ~ 97	P6 ~ P1	O	Segment control signal output
98	-VP	—	Negative power supply
99	AVSS	—	Connected to GND
100	VREF	—	Reference voltage input terminal

Replacement Parts List

Notes: * Important safety notice:

Components identified by Δ mark have special characteristics important for safety.

Furthermore, special parts which have purposes of fire-retardant (resistors), high-quality sound (capacitors), low-noise (resistors), etc. are used. When replacing any of components, be sure to use only manufacturer's specified parts shown in the parts list.

* The parenthesized indications in the Remarks columns specify the areas. (Refer to the cover page for area.)

Parts without these indications can be used for all areas.

* Capacity values are in microfarads (μ F) unless specified otherwise,

P=Pico-farads (pF) F=Farads (F)

* Resistance values are in ohms, unless specified otherwise, 1K=1,000 (OHM), 1M=1,000k (OHM)

Ref.No.	Part No.	Part Name & Description	Pcs	Remarks
1	RHD30073-K	SCREW	4	
2	XTBS26+8J	SCREW	9	
3	XTB3+8JFZ	SCREW	1	
4	REZ0883	FFC (14P)	1	
5	REZ0944	FFC (23P)	1	
6	XTBS3+8JFZ1	SCREW	10	
7	RGK0817-1M	SIDE PANEL (L)	1	
8	RKA0076-N	FOOT	4	
9	RGK0818-1M	SIDE PANEL (R)	1	
10	RMND195	FL HOLD PIECE	2	
11	SHE170-2	P. C. B. SUPPORT	4	
12	RFKGTHD51E-N	FRONT PANEL ASS'Y	1 (E)	
12	RFKGTHD51EGN	FRONT PANEL ASS'Y	1 (EG)	
13	RGK0819-N3	SIDE ORNAMENT (L)	1	
14	RGK0820-N3	SIDE ORNAMENT (R)	1	
15	XTB3+12JFZ	SCREW	4	
16	RGU1394-S	BUTTON	1 (E)	
16	RGU1394A-S	BUTTON	1 (EG)	
C101	ECBT1C103NS5	16V 0.01U	1	
C103	ECBT1C103NS5	16V 0.01U	1	
C104, 05	ECBT1H102KB5	50V 1000P	2	
C106	ECBT1C103NS5	16V 0.01U	1	
C107	ECBT1H473ZF5	50V 0.047U	1	
C108	ECBT1HBR2KC5	50V 8.2P	1	
C109, 10	ECBT1C103NS5	16V 0.01U	2	
C111	ECEA1EKA4R7B	25V 4.7U	1	
C112	ECBT1C103NS5	16V 0.01U	1	
C113	ECBT1H102KB5	50V 1000P	1	
C114	RCE1HKA3R3BG	50V 3.3U	1	
C115	ECEA1EKA4R7B	25V 4.7U	1	
C116	ECBT1C822KS5	16V 8200P	1	
C117	ECQP1391JZ3	100V 390P	1	
C118, 19	ECFR1C103KR	16V 0.01U	2	
C120, 21	ECEA1HKA010B	50V 1U	2	
C122	ECEA1HKA2R2B	50V 2.2U	1	
C123	ECEA1HKA010B	50V 1U	1	
C124	ECBT1H102KB5	50V 1000P	1	
C125	ECBT1H150JC5	50V 15P	1	

Ref.No.	Part No.	Part Name & Description	Pcs	Remarks
C126	ECBT1H473ZF5	50V 0.047U	1	
C127	ECEA1CKA220B	16V 22U	1	
C128	ECBT1H102KB5	50V 1000P	1	
C129, 30	ECEA0JKA101B	6.3V 100U	2	
C132	ECBT1H102KB5	50V 1000P	1	
C133, 34	ECBT1H270JU5	50V 27P	2	
C135, 36	ECBT1C103KS5	16V 0.01U	2	
C137, 38	ECBT1H561KB5	50V 560P	2	
C139, 40	ECBT1C682KR5	16V 6800P	2	
C141-44	ECEA1HKA010B	50V 1U	4	
C145	ECBT1H220JC5	50V 22P	1	
C148	ECBT1C103NS5	16V 0.01U	1	
C149	ECBT1H104ZF5	50V 0.1U	1	
C171, 72	ECBT1H102KB5	50V 1000P	2	
C173	ECEA1CKA220B	16V 22U	1	
C174	RCE1CKA100BG	16V 10U	1	
C181	ECBT1H471KB5	50V 470P	1	
C196	ECBT1H102KB5	50V 1000P	1	
C205-08	ECBT1H101KB5	50V 100P	4	
C209, 10	ECBT1H180J5	50V 18P	2	
C211	ECBT1H102KB5	50V 1000P	1	
C223, 24	ECBT1H104ZF5	50V 0.1U	2	
C225-27	ECBT1H470J5	50V 47P	3	
C231, 32	ECBT1E103ZF5	25V 0.01U	2	
C233, 34	ECBT1H102KB5	50V 1000P	2	
C235, 36	ECBT1H101KB5	50V 100P	2	
C237, 38	ECBT1H470J5	50V 47P	2	
C321, 22	ECBT1E103ZF5	25V 0.01U	2	
C323, 24	ECBT1H102KB5	50V 1000P	2	
C325, 26	ECBT1H101KB5	50V 100P	2	
C327, 28	RCE1AKA470BG	10V 47U	2	
C333, 34	ECBT1H221KB5	50V 220P	2	
C335, 36	RCE1CKA100BG	16V 10U	2	
C337, 38	ECEA1CKA220B	16V 22U	2	
C339, 40	RCE1CKA100BG	16V 10U	2	
C341, 42	ECEA1AKN100B	10V 10U	2	
C343	RCE1CKA100BG	16V 10U	1	
C344, 45	ECBT1H470J5	50V 47P	2	
C348	ECEA1CKA330B	16V 33U	1	
C350	ECEA0JKA470B	6.3V 47U	1	
C351, 52	RCE1CKA100BG	16V 10U	2	
C355	ECEA1CKA330B	16V 33U	1	
C356	ECBT1H104ZF5	50V 0.1U	1	
C357	RCE1AKA101BG	10V 100U	1	
C365	ECEA0JKA470B	6.3V 47U	1	
C391, 92	ECEA1CKA101B	16V 100U	2	
C393, 94	ECBT1H102KB5	50V 1000P	2	
C501	ECEA1EKA101B	25V 100U	1	
C502	ECA1VM101B	35V 100U	1	
C503	ECBT1E103ZF5	25V 0.01U	1	
C504	ECEA1EKA101B	25V 100U	1	
C509	ECBT1E103ZF5	25V 0.01U	1	
C510	RCE1AKA101BG	10V 100U	1	
C513-15	ECBT1H102KB5	50V 1000P	3	
C551	ECBT1H331KB5	50V 3300P	1 (EG)	
C552	RCE1CKA100BG	16V 10U	1 (EG)	
C553	ECBT1H104ZF5	50V 0.1U	1 (EG)	
C554	ECA0JKF101B	6.3V 100U	1 (EG)	
C555	ECBT1H561KB5	50V 560P	1 (EG)	
C556, 57	ECBT1H470J5	50V 47P	2 (EG)	
C558	ECBT1H102KB5	50V 1000P	1 (EG)	
C559	ECA0JKF101B	6.3V 100U	1 (EG)	
C601, 02	ECKR1H223ZF5	50V 0.022U	2	
Δ C603	ECA1EM102B	25V 1000U	1	
Δ C604	RCE1EM471BV	25V 470U	1	
C605, 06	ECBT1E103ZF5	25V 0.01U	2	
C607, 08	RCE1AKA470BG	10V 47U	2	
C609	ECBT1H102KB5	50V 1000P	1	
C610, 11	ECBT1H104ZF5	50V 0.1U	2	
C612	RCE1EM471BV	25V 470U	1	
C613	ECBT1E103ZF5	25V 0.01U	1	
C614	RCE1AKA470BG	10V 47U	1	
C615	ECEA1EKA101B	25V 100U	1	
C616	ECA1HM470B	50V 47U	1	
Δ C617	ECA1HM470B	50V 47U	1	

Ref.No.	Part No.	Part Name & Description	Pcs	Remarks	Ref.No.	Part No.	Part Name & Description	Pcs	Remarks
R118	ERDS2TJ472T	1/4W 4.7K	1	(EG)	R606	ERDS2FJ393	1/4W 39K	1	
R119	ERDS2TJ103T	1/4W 10K	1	(EG)	R607	ERDS2TJ153T	1/4W 15K	1	
R119	ERDS2TJ822T	1/4W 8.2K	1	(E)	△ R609	ERQ16NKW2R2E	1/6W 2.2	1	
R120	ERDS2TJ473T	1/4W 47K	1		R610	ERDS2FJ222	1/4W 2.2K	1	
R121	ERDS2TJ332T	1/4W 3.3K	1		R612	ERDS2FJ472	1/4W 4.7K	1	
R122	ERDS2FJ272	1/4W 2.7K	1		R613, 14	ERDS2FJ682	1/4W 6.8K	2	
R124	ERDS2TJ271T	1/4W 270	1		R615	ERDS2FJ103	1/4W 10K	1	
R125, 26	ERDS2TJ152T	1/4W 1.5K	2		△ R616	ERDS2FJ47	1/4W 4.7	1	
R127	ERDS2FJ103	1/4W 10K	1		R621, 22	ERDS2TJ151T	1/4W 150	2	
R128	ERDS2TJ820T	1/4W 82	1		R623, 24	ERDS2FJ224	1/4W 220K	2	
R129	ERDS2TJ473T	1/4W 47K	1		R627-30	ERDS2FJ472	1/4W 4.7K	4	
R130	ERDS2FJ103	1/4W 10K	1		R631, 32	ERDS2TJ471T	1/4W 470	2	
R132	ERDS2FJ103	1/4W 10K	1		R635, 36	ERDS2FJ472	1/4W 4.7K	2	
R133-37	ERDS2FJ102	1/4W 1K	5		R637, 38	ERDS2FJ150	1/4W 15	2	
R138	ERDS2FJ103	1/4W 10K	1		R641, 42	ERDS2TJ471T	1/4W 470	2	
R139, 40	ERDS2FJ272	1/4W 2.7K	2		R656	ERDS2TJ221T	1/4W 220	1	
R141, 42	ERDS2FJ102	1/4W 1K	2		R901	ERDS2TJ821T	1/4W 820	1	
R143, 44	ERDS2FJ222	1/4W 2.2K	2		R902	ERDS2FJ102	1/4W 1K	1	
R145, 46	ERDS2TJ821T	1/4W 820	2		R903	ERDS2TJ122T	1/4W 1.2K	1	
R147, 48	ERDS2FJ474	1/4W 470K	2		R904	ERDS2TJ152T	1/4W 1.5K	1	
R149	ERDS2FJ680	1/4W 68	1		R905	ERDS2TJ182F	1/4W 1.8K	1	
R171, 72	ERDS2FJ102	1/4W 1K	2		R906	ERDS2FJ222	1/4W 2.2K	1	
R173	ERDS2TJ471T	1/4W 470	1		R907	ERDS2TJ332T	1/4W 3.3K	1	
R175	ERDS2FJ102	1/4W 1K	1		R908	ERDS2FJ472	1/4W 4.7K	1	
R176	ERDS2TJ391T	1/4W 390	1		R909	ERDS2FJ682	1/4W 6.8K	1	
R177	ERDS2TJ472T	1/4W 4.7K	1	(EG)	R911	ERDS2TJ473T	1/4W 47K	1	
R205, 06	ERDS2FJ224	1/4W 220K	2		R916-19	ERDS2FJ103	1/4W 10K	4	
R207, 08	ERDS2FJ102	1/4W 1K	2		R920-22	ERDS2FJ102	1/4W 1K	3	
R209-12	ERDS2TJ822T	1/4W 8.2K	4		R923	ERDS2TJ391T	1/4W 390	1	
R225, 26	ERDS2TJ122T	1/4W 1.2K	2		R925	ERDS2FJ102	1/4W 1K	1	
R229-31	ERDS2FJ222	1/4W 2.2K	3		R926, 27	ERDS2FJ101	1/4W 100	2	
R233, 34	ERDS2TJ223T	1/4W 22K	2		R928	ERDS2FJ102	1/4W 1K	1	
R235, 36	ERDS2TJ822T	1/4W 8.2K	2		R929	ERDS2FJ101	1/4W 100	1	
R237, 38	ERDS2TJ123T	1/4W 12K	2		R930-33	ERDS2FJ102	1/4W 1K	4	
R239-44	ERDS2FJ102	1/4W 1K	6		R934	ERDS2FJ101	1/4W 100	1	
R331, 32	ERDS2FJ102	1/4W 1K	2		R935	ERDS2FJ102	1/4W 1K	1	
R333, 34	ERDS2FJ104	1/4W 100K	2		R936	ERDS2FJ472	1/4W 4.7K	1	(E)
R335, 36	ERDS2TJ562	1/4W 5.6K	2		R936	ERDS2TJ101T	1/4W 100	1	(EG)
R337, 38	ERDS2TJ123T	1/4W 12K	2		R937	ERDS2FJ101	1/4W 100	1	
R339, 40	ERDS2TJ471T	1/4W 470	2		R938	ERDS2FJ102	1/4W 1K	1	
R341, 42	ERDS2TJ122T	1/4W 1.2K	2		R939	ERDS2FJ101	1/4W 100	1	
R343, 44	ERDS2FJ224	1/4W 220K	2		R940, 41	ERDS2FJ393	1/4W 39K	2	
R345-48	ERDS2FJ103	1/4W 10K	4		R942	ERDS2FJ472	1/4W 4.7K	1	
R349, 50	ERDS2FJ102	1/4W 1K	2		R944	ERDS2TJ473T	1/4W 47K	1	
R351	ERDS2TJ182T	1/4W 1.8K	1		R945, 46	ERDS2FJ102	1/4W 1K	2	
R352	ERDS2FJ102	1/4W 1K	1		R947-49	ERDS2FJ103	1/4W 10K	3	
R353	ERDS2TJ182T	1/4W 1.8K	1		R950	ERDS2FJ102	1/4W 1K	1	
R354, 55	ERDS2FJ222	1/4W 2.2K	2		R951	ERDS2FJ104	1/4W 100K	1	
R356-58	ERDS2TJ391T	1/4W 390	3		R952, 53	ERDS2FJ102	1/4W 1K	2	
R361, 62	ERDS2TJ223T	1/4W 22K	2		R954	ERDS2FJ101	1/4W 100	1	
R363, 64	ERDS2FJ102	1/4W 1K	2		R955	ERDS2TJ824T	1/4W 820K	1	
R365, 66	ERDS2FJ105	1/4W 1M	2		R956	ERDS2FJ101	1/4W 100	1	
R372	ERDS2FJ105	1/4W 1M	1		R957	ERDS2FJ102	1/4W 1K	1	
R374	ERDS2TJ182T	1/4W 1.8K	1		R958	ERDS2TJ471T	1/4W 470	1	
R375, 76	ERDS2FJ102	1/4W 1K	2		R959, 60	ERDS2TJ223T	1/4W 22K	2	
R377, 78	ERDS2TJ121T	1/4W 120	2		R961	ERDS2FJ103	1/4W 10K	1	
R379, 80	ERDS2TJ223T	1/4W 22K	2		R962	ERDS2TJ473T	1/4W 47K	1	
R381	ERDS2FJ105	1/4W 1M	1		R963, 64	ERDS2FJ103	1/4W 10K	2	
R382	ERDS2FJ472	1/4W 4.7K	1		R965	ERDS2FJ472	1/4W 4.7K	1	
R383	ERDS2TJ223T	1/4W 22K	1		R966	ERDS2TJ223T	1/4W 22K	1	
R397, 98	ERQ16NKW2R2E	1W 2.2	2		R967	ERDS2FJ472	1/4W 4.7K	1	
R501	ERDS2TJ152T	1/4W 1.5K	1		R968, 69	ERDS2TJ152T	1/4W 1.5K	2	
R502	ERDS2TJ221T	1/4W 220	1		R970	ERDS2TJ473T	1/4W 47K	1	
R506	ERDS2TJ152T	1/4W 1.5K	1		R971	ERDS2FJ104	1/4W 100K	1	
R507	ERDS2TJ221T	1/4W 220	1		R978-93	ERDS2FJ104	1/4W 100K	16	
R508, 09	ERDS2TJ223T	1/4W 22K	2		R994	ERDS2FJ102	1/4W 1K	1	
R511, 12	ERDS2FJ472	1/4W 4.7K	2		R997-99	ERDS2FJ102	1/4W 1K	3	
R551	ERDS2TJ104T	1/4W 100K	1	(EG)					
R552, 53	ERDS2TJ102T	1/4W 1K	2	(EG)	△ RL601	RSY0017M-0	RELAY	1	
R554	ERDS2TJ103T	1/4W 10K	1	(EG)					
R555, 56	ERDS2TJ102T	1/4W 1K	2	(EG)	S901-10	EVQPTD05Q	SW	10	
R563	ERDS2TJ332T	1/4W 3.3K	1	(EG)					
△ R601, 02	ERD2FCJ47	1/4W 4.7	2		X101	RSXZ456K07M	OSCILLATOR	1	
R603, 04	ERDS2FJ102	1/4W 1K	2		X102	RLF0GT05DD	OSCILLATOR	1	
R605	ERDS2FJ101	1/4W 100	1		X103	RSXC7M20S05T	OSCILLATOR	1	

Cabinet Parts Location

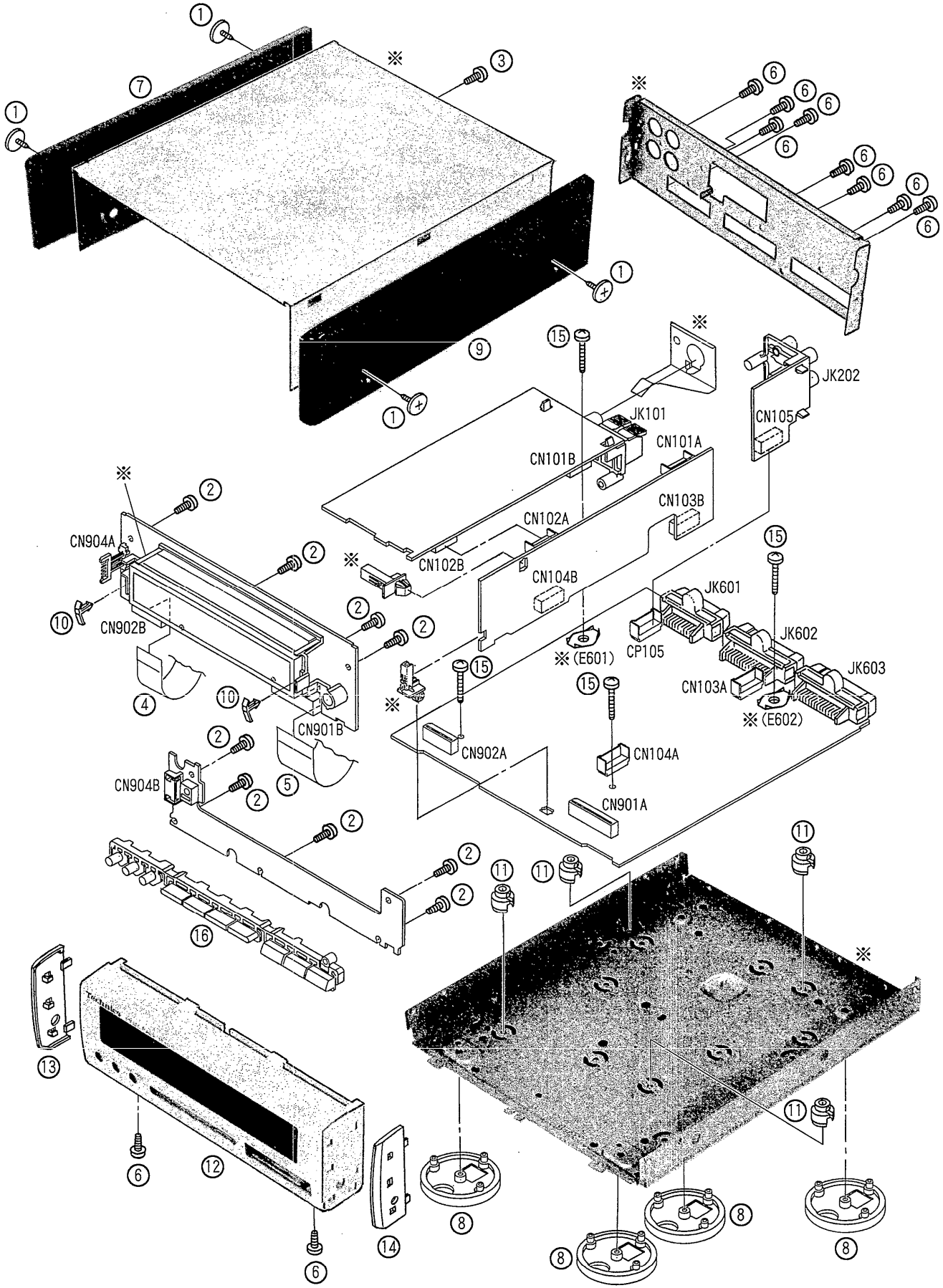

※ : Not supplies.

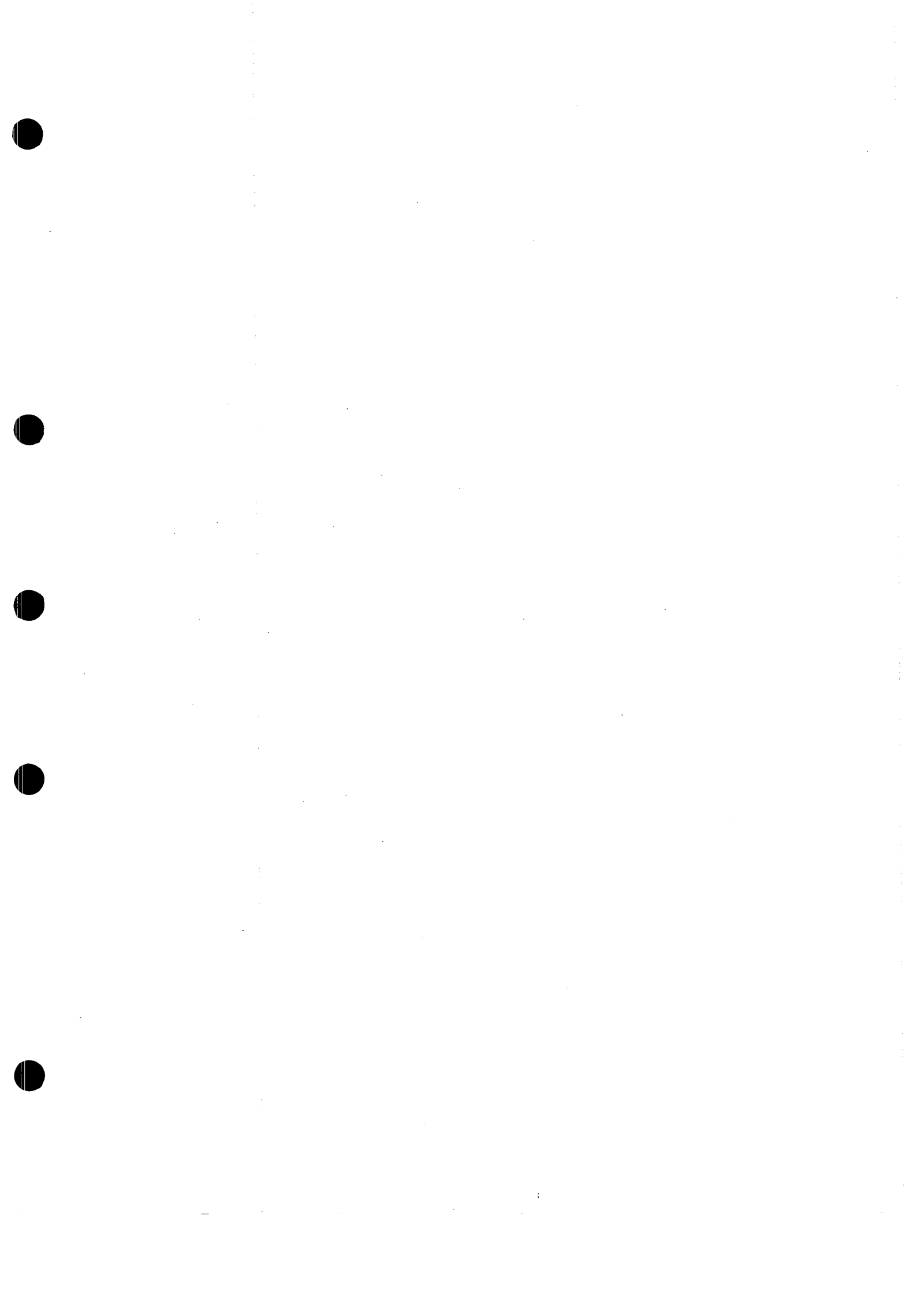

026